



MAKERS OF RESPIRATORY VALVES SINCE 1938

**HANS RUDOLPH, inc.**

www.rudolphkc.com

TEL: (913) 422-7788

U.S.A. & CANADA: (800) 456-6695

FAX: (913) 422-3337

E-Mail: hri@rudolphkc.com

8325 COLE PARKWAY, SHAWNEE, KANSAS 66227 U.S.A.

*Data Sheet...*

**6600 Series V2 Mask™**

**ORO-NASAL CPAP/BiLevel with AAV & Vents**  
**SINGLE PATIENT USE**

**Large, Medium, Small, Extra Small, Petite**

#### PRODUCT FEATURES

- **Five Sizes** to cover a wide range of patient sizes.
- **Face Piece with new Facial Sealing Flange** is a single piece mask, made of clear soft Thermoplastic Elastomer.
- **Anatomically Contoured Face Mask Design with ribbed support** for a leak free comfortable fit.
- **Anti-Asphyxia Valve (AAV)** for patient safety - allows patient to breathe room air if the flow device malfunctions. Valve opens at mask pressures less than 3cm H<sub>2</sub>O.
- **Swivel Port Micro Vent Holes** dissipate CO<sub>2</sub>.
- **360° Dual Swivel Elbow Port with Detachable Swivel Port** for improved patient freedom of movement. Color coded translucent blue.
- **Easily adjustable, light weight, 4 strap Headgear** for patient comfort, available in three sizes.
- **New Quick-Release Strap Clips** for quick & simple mounting & dismounting of headgear.
- **Lightweight, easy to use, high quality mask & headgear.**
- **Low Cost, Disposable mask.**

#### SPECIFICATIONS

MATERIALS (See Fig. A)	
Face Piece with Structural Braces	Thermoplastic Elastomer, Polycarbonate Thermoplastic
Swivel Port - Mask Adapter, Elbow, 22mm Port	Polycarbonate Thermoplastic, Translucent Blue
Swivel Port - AAV Port	Polycarbonate Thermoplastic Translucent
Diaphragm	Silicone Rubber
Headgear	Polyurethane Foam Black, Nylon UBL Black and Blue
Headgear Hook	Nylon, Black
Headgear Strap Clips (4), Tri-glide	Polypropylene, Black

#### GENERAL INFORMATION

- **Intended Use:** The Hans Rudolph 6600 V2 Mask™ series are disposable, single-patient use, adult Oro-Nasal CPAP/BiLevel mask which incorporates passive, continuous flow exhaust ports built into the mask. It is intended for use with CPAP/BiLevel machines for treatment of obstructive sleep apnea, and for use with other similar ventilators that use this exhaust port configuration providing a minimum of 3 cmH<sub>2</sub>O pressure measured at the mask.
- **Indications for Use:** The V2 Mask™ are for use on adult patients (greater than 30 kilograms weight) for treatment of Obstructive Sleep Apnea or any other conditions requiring CPAP/BiLevel or non-invasive ventilatory support at pressures greater than or equal to 3.0 cmH<sub>2</sub>O at the mask in hospitals and other clinical settings.
- **Environment of Use:** The V2 Masks™ are for use in hospitals and other clinical settings by individuals that have at least minimal instructions or training on the use of the mask as well as the device to which the mask are intended to connect.
- **Cautions:**
  - a.) Federal law restricts this device to sale by or on the order of a physician.
  - b.) At low CPAP/BiLevel pressures the flow through the mask vent holes may be inadequate to clear all exhaled gas from the tubing. Some rebreathing may occur.
  - c.) Patients with facial hair, especially beards, may experience mask leakage which may require shaving the hair.
- **Warnings:** Refer to: Instructions for Use, Document No. 691273, shipped with product.
- **Contraindications & Complications:** Refer to: Instructions for Use, Document No. 691273, shipped with product.

#### PHYSICAL CHARACTERISTICS

##### Face Mask Dimensions

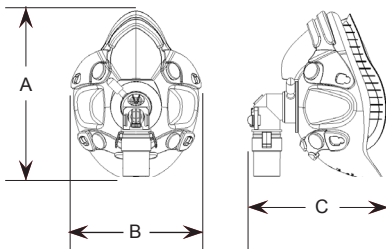

Mask DeadSpace Volume (ml) Measured up to vent in Swivel Port				
Large	Medium	Small	Extra Small	Petite
154	136	110	99	89

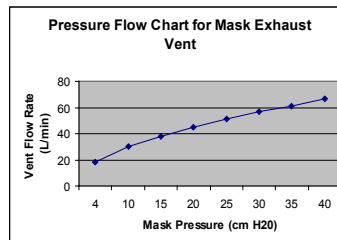

MASK SIZE WITH OVERALL DIMENSIONS - inches (mm)					
	LARGE	MEDIUM	SMALL	EXTRA SMALL	PETITE
A	5.9 (150)	5.5 (140)	5.2 (132)	4.8 (122)	4.6 (117)
B	4.2 (107)	4.16 (105)	4.05 (103)	3.95 (100)	3.9 (99)
C	4.7 (119)	4.46 (113)	4.32 (110)	4.2 (107)	4.04 (103)



**Oro-Nasal CPAP/BiLevel V2 Mask™ with Headgear**

#### 6600 V2 Mask™ COMPONENTS FIG. A

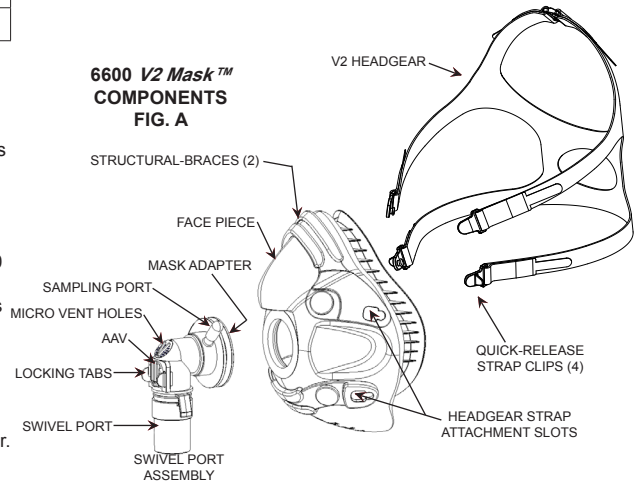

#### MASK SIZING GAUGE

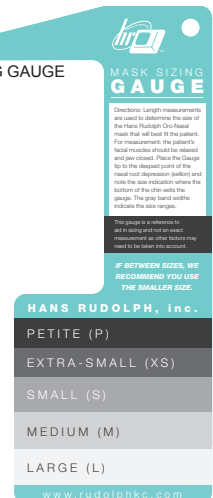

**ORDERING INFORMATION - 6600 Series Disposable V2 Oro-Nasal Mask with Elbow Swivel Port 22mm OD Vented with Anti-Asphyxia Valve (AAV) & Headgear (HG)**

P/N	Mask, AAV Valve, Vented 22mm OD Elbow & HG
113555	6600 <b>Large</b>
113556	6600 <b>Medium</b>
113557	6600 <b>Small</b>
113558	6600 <b>Extra Small</b>
113559	6600 <b>Petite</b>
<b>MINIMUM ORDER REQUIRES 18 EACH OF ONE P/N</b>	

	<b>Accessories</b>
691143	<b>Mask Sizing Gauge</b> for V2 Oro-Nasal Masks
669353	METRO™ NG Tube Seal Disposable Package of 1



1846 5th Concession W., P.O. Box 7, Rockton, Ontario L0R 1X0  
 Tel. (519) 622-4030 • Toll Free Line 1-800-996-6674 • Fax (519) 622-1142  
[www.mcarthurmedical.com](http://www.mcarthurmedical.com) • [mmsi@mcarthurmedical.com](mailto:mmsi@mcarthurmedical.com)

